

SURVEYOR'S OFFICE

Hamilton County

Kenton C. Ward, Surveyor

Phone (317) 776-8495

Tax (317) 776-9628

Suite 188

One Hamilton County Square

Noblesville, Indiana 46060-2230

September 30, 2005

To: Hamilton County Drainage Board

Re: Village of West Clay Drain, Section 9003 Arm

Attached is a petition filed by Brenwick Development along with a non-enforcement request, plans, calculations, quantity summary and assessment roll for the Section 9003 Arm, Village of West Clay Drain to be located in Clay Township. I have reviewed the submittals and petition and have found each to be in proper form.

I have made a personal inspection of the land described in the petition. Upon doing so, I believe that the drain is practicable, will improve the public health, benefit a public highway, and be of public utility and that the costs, damages and expenses of the proposed drain will probably be less than the benefits accruing to the owners of land likely to be benefited. The drain will consist of the following:

12" RCP	573 ft	18" RCP	159 ft	30" RCP	110 ft
15" RCP	516 ft	24" RCP	23 ft	36" RCP	717 ft

The total length of the drain will be 2,098 feet.

This section of the Village of West Clay intercepts the 24" outlet for the Village of Towne Pointe Development and removes the 856 feet of temporary 15" HDPE pipe that is mentioned in my report to the Board for Elliott Creek Drain, Village of Towne Pointe Arm. Report dated December 3, 2004, approved at hearing on January 24, 2005, Drainage Board Minute Book 8, pages 154 and 155. The existing 24" RCP outlet is to be connected to the drainage system for this section at Structure Number 690.

The subsurface drains (SSD) under curbs are not to be part of the regulated drain. This is per the agreement between Brenwick Development and the Hamilton County Commissioners on April 26, 1999. (See Commissioner's Minute Book 93, Pages 565-566).

I have reviewed the plans and believe the drain will benefit each lot equally. Therefore, I recommend each lot be assessed equally. I also believe that no damages will result to landowners by the construction of this drain. I recommend a maintenance assessment of \$5.00 per acre, \$5.00 per acre for roadways, with a \$120.00 minimum. With this assessment the total annual assessment for this drain/this section will be \$3,276.30.

The petitioner has submitted surety for the proposed drain at this time. The sureties which are in the form of a Performance Bond are as follows:

Agent: Bond Safeguard Insurance Co.
Date: September 7, 2005
Number: 5018115
For: Storm Sewers
Amount: \$107,203.00

Agent: Bond Safeguard Insurance Company
Date: September 7, 2005
Number: 5018116
For: Erosion Control
Amount: \$16,800.00

Parcels assessed for this drain may be assessed for the Collins-Osborn or William Creek Drain at sometime in the future. Parcels assessed for this drain will also be assessed for the Elliott Creek Drain.

I believe this proposed drain meets the requirements for Urban Drain Classification as set out in IC36-9-27-67 to 69. Therefore, this drain shall be designated as an Urban Drain.

I recommend that upon approval of the above proposed drain that the Board also approve the attached non-enforcement request. The request is for the reduction of the regulated drain easement to those easement widths as shown on the secondary plat for Village of West Clay Section 9003 as recorded in the office of the Hamilton County Recorder.

I recommend the Board set a hearing for this proposed drain for November 28, 2005.

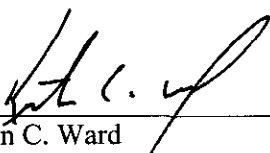

Kenton C. Ward
Hamilton County Surveyor

KCW/llm

STATE OF INDIANA)
)
COUNTY OF HAMILTON)

TO: HAMILTON COUNTY DRAINAGE BOARD

% Hamilton County Surveyor
One Hamilton County Square, Suite 188
Noblesville, IN. 46060-2230

In the matter of Village of WestClay Subdivision, Section
9003 Drain Petition.

Petitioner is the owner of all lots in the land affected by the proposed new regulated drain. The drainage will affect various lots in Village of WestClay, a subdivision in Hamilton County, Indiana. The general route of such drainage shall be in existing easements and along public roads as shown in the plans on file in the Surveyor's Office.

Petitioner believes that the cost, damages and expenses of the proposed improvement will be less than the benefits which will result to the owners of the land likely to be benefited thereby. Petitioner believes the proposed improvements will:

- (a) improve public health
- (b) benefit a public street
- (c) be of public utility

Petitioner agrees to pay the cost of construction of the drainage system and requests periodic maintenance assessments by the Board thereafter.

The Petitioner also agrees to the following:

1. To provide the Drainage Board a Performance Bond or Non-Revocable Letter of Credit for the portion of the drainage system which will be made a regulated drain. The bond will be in the amount of 120% of the Engineer's estimate. The bond will be in effect until construction of 100% of the system is completed and so certified by the Engineer.
2. The Petitioner shall retain an Engineer throughout the construction phase. At completion of the project the Petitioner's Engineer shall certify that the drainage system which is to be maintained as a regulated drain has been constructed as per construction plans.
3. The Petitioner agrees to request in writing to the County Surveyor any changes from the approved plan and must receive written authorization from the County Surveyor prior to implementation of the change. All changes shall be documented and given to the Surveyor to be placed in the Drain file.
4. The Petitioner shall instruct his Engineer to provide a reproducible print on a 24" x 36" Mylar of the final design of the Drainage System. This shall be submitted to the County Surveyor prior to the release of the Performance Bond.
5. The Petitioner shall comply with the Erosion Control Plan as specified on the construction plans. Failure to comply with the Erosion Control Plan shall be determined by the Board as being an obstruction to the drainage system. The County Surveyor shall immediately install or repair the needed measures at Petitioners cost as per IC 36-9-27-46.

The Petitioner further requests that the Drain be classified as an Urban Drain as per IC 36-9-27-69(d).

RECORDED OWNER(S) OF LAND INVOLVED

Signed

Signed

KEVIN GRULIK
Printed Name

AGENT TO: BRENNICK TND COMMUNITIES, LLC (OWNER)
Printed Name

Date

Date

Signed

Signed

Printed Name

Printed Name

Date

Date

FINDINGS AND ORDER

CONCERNING THE MAINTENANCE OF THE

Village of West Clay Drain, Section 9003 Arm

On this *28th day of November 2005*, the Hamilton County Drainage Board has held a hearing on the Maintenance Report and Schedule of Assessments of the *Village of West Clay Drain, Section 9003 Arm*.

Evidence has been heard. Objections were presented and considered. The Board then adopted the original/amended Schedule of Assessments. The Board now finds that the annual maintenance assessment will be less than the benefits to the landowners and issues this order declaring that this Maintenance Fund be established.

HAMILTON COUNTY DRAINAGE BOARD



President



Member

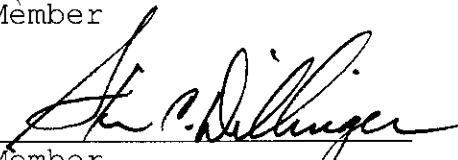

Member

Attest: 

CERTIFICATE OF COMPLETION AND COMPLIANCE

TO: HAMILTON COUNTY SURVEYOR
RE: Village of West Clay Section 9003

I hereby certify that:

1. I am a Register Engineer in the State of Indiana
2. I am familiar with the plans and specifications for the above referenced subdivision.
3. I have personally observed and supervised the completion of the Drainage Facilities for the above referenced subdivision, and
4. The drainage facilities within the above referenced subdivision to the best of my knowledge, information, and belief have been installed and completed in conformity with all plans and specifications.
5. The drainage facilities within the above referenced subdivision to the best of my knowledge, information and belief have been correctly represented on the Record Drawings, Digital Record Drawings and the Structure Data Spreadsheet.

Signature:  Date: 4-6-06

Type or print name: Brandon T Burke, P.E.

Business /Address: The Schneider Corporation

12821 E. New Market Street, Suite 301, Carmel, IN 46032

Telephone: (317) 826-6401

INDIANA REGISTRATION NUMBER

PE 10000075

SEAL



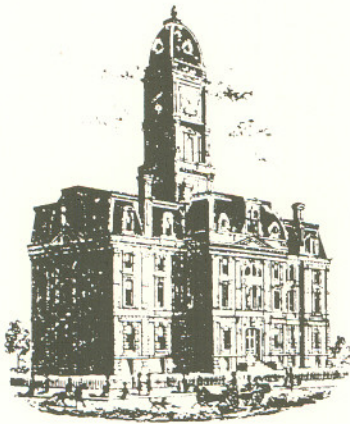

SURVEYOR'S OFFICE

Hamilton County

Kenton C. Ward, CEM
 Surveyor of Hamilton County
 Phone (317) 776-8495
 Fax (317) 776-9628

Suite 188
 One Hamilton County Square
 Noblesville, Indiana 46060-2230

To: Hamilton County Drainage Board

March 21, 2007

Re: Village West Clay: Section 9003

Attached are as-builts, certificate of completion & compliance, and other information for Villages of West Clay Section 9003. An inspection of the drainage facilities for this section has been made and the facilities were found to be complete and acceptable.

During construction, changes were made to the drain, which will alter the plans submitted with my report for this drain-dated September 30, 2005. The report was approved by the Board at the hearing held December 22, 2005. (See Drainage Board Minutes Book 8, Pages 558-559) The changes are as follows:

Structure:	Length:	Size	Material:	Up Invert:	Dn Invert	Grade:	Changes(ft):
691-690A	41	15	RCP	896.33	895.6	1.78	1
690A-690	184	15	RCP	895.6	895.17	0.23	-9
690-689	114	30	RCP	895.17	895.01	0.14	4
689-688	187	36	RCP	895.01	894.45	0.3	1
688-687	122	36	RCP	894.55	894.15	0.25	-1
687-686	354	36	RCP	894.15	893.36	0.22	1
686-685	46	36	RCP	893.36	893.12	0.52	-9
708-707	111	12	RCP	897.71	896.89	0.74	1
707-706A	127	15	RCP	896.89	896.41	0.38	1
706A-706	29	15	RCP	896.41	896.3	0.38	2
706-705	29	15	RCP	896.3	896.21	0.31	
705-689	159	18	RCP	896.21	895.79	0.26	
698-697	29	12	RCP	896.48	896.4	0.28	
697-696	156	12	RCP	896.4	895.85	0.35	-1
696-695	110	12	RCP	895.85	895	0.77	
702-695	29	12	RCP	896.53	896.48	0.17	
695-688	92	15	RCP	895	894.55	0.49	-7
701-700	29	12	RCP	897.38	897.14	0.83	
700-696	111	12	RCP	897.14	896.46	0.61	2
Ex-690	18	24	RCP		895.27		-5

RCP Pipe Totals:

12	575
15	502
18	159
24	18
30	114
36	709
Total:	<u>2077</u>

The length of the drain due to the changes described above is now **2,077 feet**.

The non-enforcement was approved by the Board at its meeting on December 22, 2005 and recorded under instrument #200600019146, #200600019147.

The following sureties were guaranteed by Bond Safeguard Insurance Company and released by the Board on its December 21, 2006 meeting.

Bond-LC No: 5018115
Insured For: Storm Sewers
Amount: \$107,203.00
Issue Date: September 7, 2005

Bond-LC No: 5018116
Insured For: Erosion Control
Amount: \$16,800.00
Issue Date: September 7, 2005

I recommend the Board approve the drain's construction as complete and acceptable.

Sincerely,



Kenton C. Ward, CFM
Hamilton County Surveyor

KCW/slm

DRAIN: #317 VOWC
~~ELLIOT CREEK DRAIN~~
 IMPROVEMENT-ARM: WEST CLAY 900B
 HEARING DATE: Dec 22, 2005
 DRAIN BOOK & PAGE: BK 8 pg 558-559
 Rpt Sept 27, 2005

FINAL REPORT CHECKLIST

- RELEASE BONDS 12-21-06
- NON-ENFORCEMENT VOWC # 2006 00019146 g EC #2006 00019147
- ENG CERT OF CC APR 10, 2006
- ASBUILTS "
- FIGURE PIPE LENGTHS _____
- ENTER INTO GIS 3-15-07
- WRITE FINAL REPORT _____
- ENTER INTO POSSE _____
- ENTER INTO GASB 34 SPREADSHEET _____
- SCAN SURVEYOR'S REPORTS _____
- EMAIL WORD FILES TO LYNNETTE _____
- COPIES OF REPORTS TO LYNNETTE _____

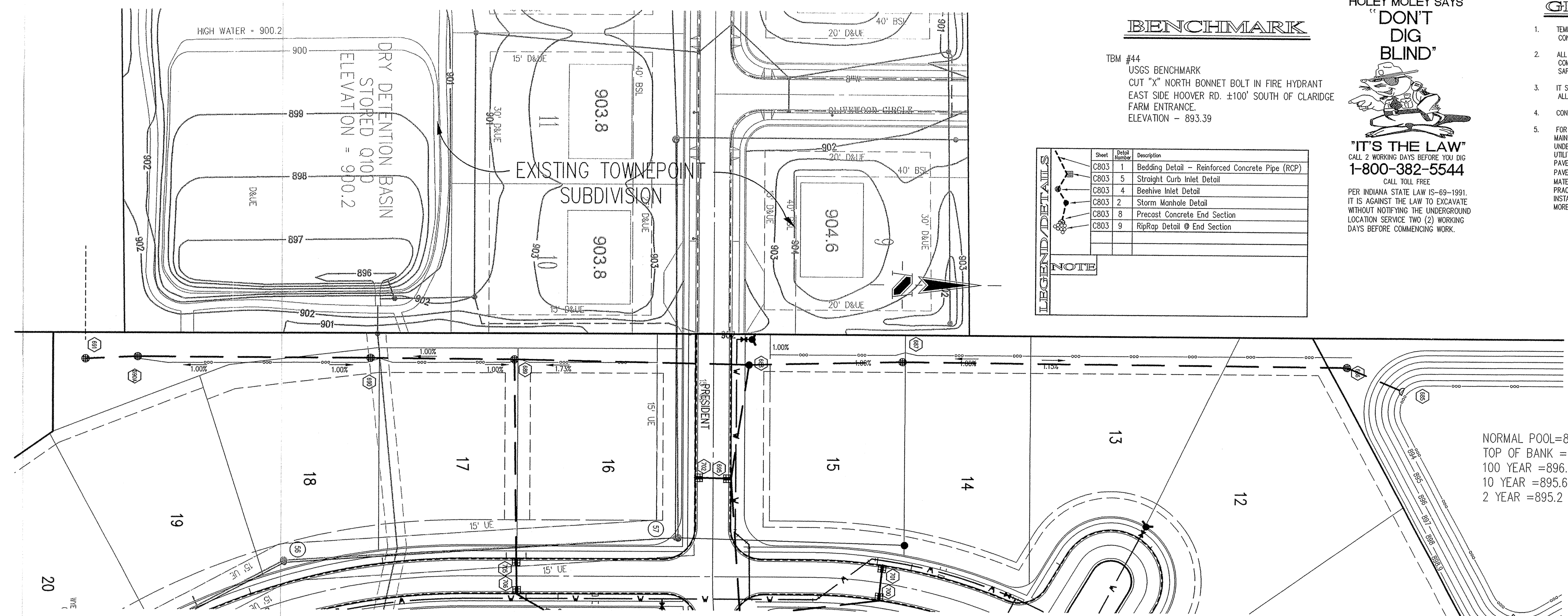

BENCHMARK

TBM #44
 USGS BENCHMARK
 CUT "X" NORTH BONNET BOLT IN FIRE HYDRANT
 EAST SIDE HOOVER RD. ±100' SOUTH OF CLARIDGE
 FARM ENTRANCE.
 ELEVATION = 893.39

HOLEY MOLEY SAYS
"DON'T DIG BLIND"

"IT'S THE LAW"
 CALL 2 WORKING DAYS BEFORE YOU DIG
1-800-382-5544
 CALL TOLL FREE
 PER INDIANA STATE LAW 15-69-1991.
 IT IS AGAINST THE LAW TO EXCAVATE
 WITHOUT NOTIFYING THE UNDERGROUND
 LOCATION SERVICE TWO (2) WORKING
 DAYS BEFORE COMMENCING WORK.

GENERAL NOTES

- TEMPORARY TRAFFIC CONTROL DURING CONSTRUCTION TO CONFORM TO APPLICABLE LOCAL AND STATE STANDARDS.
- ALL CONSTRUCTION ACTIVITY ON THIS SITE TO BE PERFORMED IN COMPLIANCE WITH APPLICABLE O.S.H.A. STANDARDS FOR WORKER SAFETY.
- IT SHALL BE THE CONTRACTORS RESPONSIBILITY TO FIELD VERIFY ALL UTILITY LOCATIONS BEFORE CONSTRUCTION BEGINS.
- CONTRACTORS SHALL MINIMIZE DAMAGE TO EXISTING TREES.
- FOR INSTALLATION OF STORM MAINS, WATER MAINS, SANITARY MAINS, WATER SERVICE LATERALS, SANITARY SERVICE LATERALS UNDER CITY STREETS, REGARDLESS OF THE JURISDICTION OF THE UTILITY, THE MINIMUM COVER FROM THE TOP OF THE INSTALLED PAVEMENT TO THE TOP OF THE INSTALLED PIPE SHALL BE THE PAVEMENT SECTION THICKNESS (ALL BITUMINOUS AND AGGREGATE MATERIAL ABOVE THE SUBGRADE) PLUS 1'-0". IF THE STANDARD PRACTICE OF THE UTILITY THAT HAS JURISDICTION OVER THE INSTALLATION HAS A MORE STRINGENT COVER REQUIREMENT, THE MORE STRINGENT REQUIREMENT SHALL GOVERN.

LEGEND/DETAILS

Sheet	Detail Number	Description
C803	1	Bedding Detail - Reinforced Concrete Pipe (RCP)
C803	5	Straight Curb Inlet Detail
C803	4	Beehive Inlet Detail
C803	2	Storm Manhole Detail
C803	8	Precast Concrete End Section
C803	9	RipRap Detail @ End Section

NORMAL POOL=893.1
 TOP OF BANK =898.9
 100 YEAR =896.9
 10 YEAR =895.6
 2 YEAR =895.2

STORM SEWER PLAN

SCALE: 1"=50'

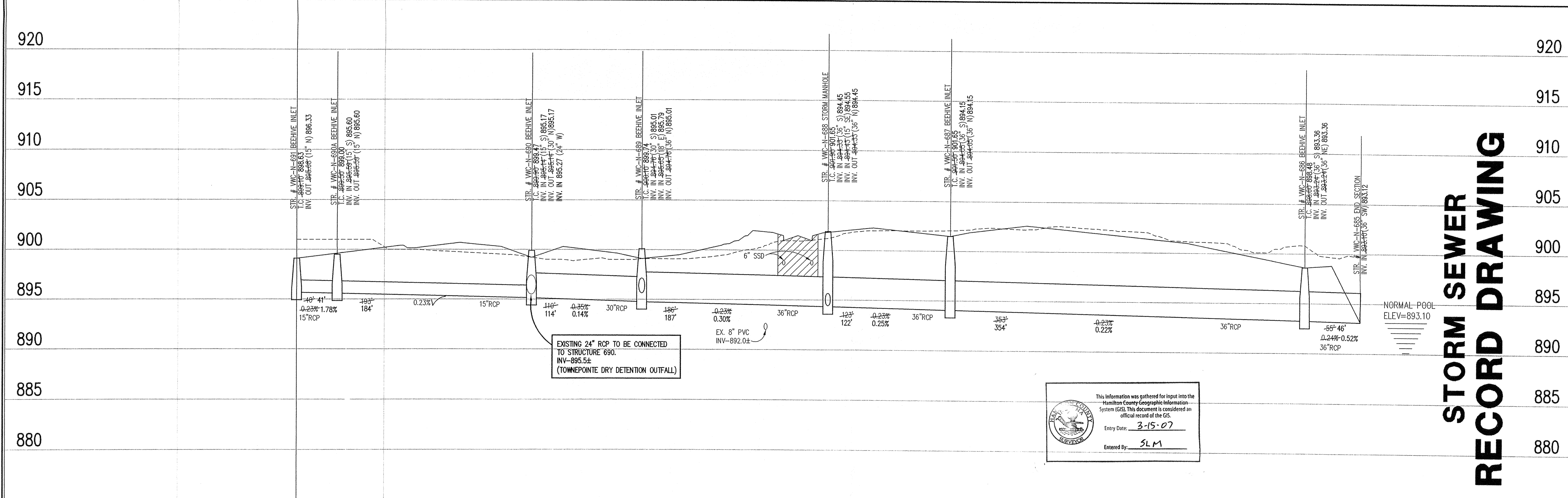

STORM SEWER RECORD DRAWING

This information was gathered for input into the Hamilton County Geographic Information System GIS. This document is considered an official record of the GIS.
 Entry Date: 3-15-07
 Entered By: SLM

EXISTING 24" RCP TO BE CONNECTED TO STRUCTURE 690. INV=895.5± (TOWNEPONT DRY DETENTION OUTFALL)

LEGEND

	Existing Grade
	New Grade
	Granular Backfill

SCALE: HORZ.: 1"=50'
 VERT.: 1"=5'

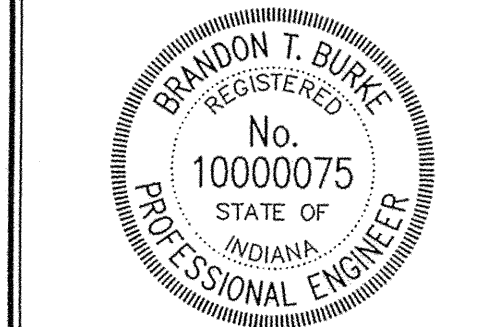

Brandon T. Burke
 DATE: 6/10/05
 THIS DRAWING AND THE IDEAS, DESIGNS AND CONCEPTS CONTAINED HEREIN ARE THE EXCLUSIVE INTELLECTUAL PROPERTY OF THE SCHNEIDER CORPORATION AND ARE NOT TO BE USED OR REPRODUCED, IN WHOLE OR IN PART, WITHOUT THE WRITTEN CONSENT OF THE SCHNEIDER CORPORATION.
 © COPYRIGHTED BY THE SCHNEIDER CORP. (2004)



THE SCHNEIDER CORPORATION
 12821 E. New Market Street
 Suite 100
 Carmel, IN 46032
 Telephones: 317.569.8112
 Fax: 317.826.6410
 www.schneidercorp.com

- Architecture
- Civil Engineering
- Environmental Engineering
- Geotechnical Services
- SIS * LIS
- Home Builder Services
- Interior Design
- Land Surveying
- Landscape Architecture
- Transportation Engineering

Village of WestClay
 SECTION 9003
 CARMEL, INDIANA
 BREWICK DEVELOPMENT CO.
 CARMEL, INDIANA

DATE: 6/10/05	PROJECT NO.: 1238.9003
DRAWN BY: DCC	CHECKED BY:
SHEET TITLE: STORM SEWER PLAN & PROFILE	
DRAWING FILES: N:\1238\9003\DWG\C801-602.DWG XREF: 1012-BS.DWG XREF: 9002-BS.DWG, 9003-BS.DWG XREF: STORM.DWG XREF: TOWNEPONT.DWG XREF: 0416.DWG	

SHEET NO.: **C601**

BENCHMARK

TBM #44
USGS BENCHMARK
CUT "X" NORTH BONNET BOLT IN FIRE HYDRANT
EAST SIDE HOOVER RD. ±100' SOUTH OF CLARIDGE
FARM ENTRANCE.
ELEVATION - 893.39

Sheet	Detail	Description
C803	1	Bedding Detail - Reinforced Concrete Pipe (RCP)
C803	5	Straight Curb Inlet Detail
C803	4	Beehive Inlet Detail
C803	2	Storm Manhole Detail
C803	8	Precast Concrete End Section
C803	9	RipRap Detail @ End Section

HOLEY MOLEY SAYS

"DON'T DIG BLIND"



"IT'S THE LAW"
CALL 2 WORKING DAYS BEFORE YOU DIG
1-800-382-5544

CALL TOLL FREE
PER INDIANA STATE LAW IS-59-1991
IT IS AGAINST THE LAW TO EXCAVATE
WITHOUT NOTIFYING THE UNDERGROUND
LOCATION SERVICE TWO (2) WORKING
DAYS BEFORE COMMENCING WORK.

GENERAL NOTES

- TEMPORARY TRAFFIC CONTROL DURING CONSTRUCTION TO CONFORM TO APPLICABLE LOCAL AND STATE STANDARDS.
- ALL CONSTRUCTION ACTIVITY ON THIS SITE TO BE PERFORMED IN COMPLIANCE WITH APPLICABLE O.S.H.A. STANDARDS FOR WORKER SAFETY.
- IT SHALL BE THE CONTRACTORS RESPONSIBILITY TO FIELD VERIFY ALL UTILITY LOCATIONS BEFORE CONSTRUCTION BEGINS.
- CONTRACTORS SHALL MINIMIZE DAMAGE TO EXISTING TREES.
- FOR INSTALLATION OF STORM MAINS, WATER MAINS, SANITARY MAINS, WATER SERVICE LATERALS, SANITARY SERVICE LATERALS UNDER CITY STREETS, REGARDLESS OF THE JURISDICTION OF THE UTILITY, THE MINIMUM COVER FROM THE TOP OF THE INSTALLED PAVEMENT TO THE TOP OF THE INSTALLED PIPE SHALL BE THE PAVEMENT SECTION THICKNESS (ALL BITUMINOUS AND AGGREGATE MATERIAL ABOVE THE SUBGRADE) PLUS 1'-0". IF THE STANDARD PRACTICE OF THE UTILITY THAT HAS JURISDICTION OVER THE INSTALLATION HAS A MORE STRINGENT COVER REQUIREMENT, THE MORE STRINGENT REQUIREMENT SHALL GOVERN.

REVISIONS:
1. REV. 11/09/05, REVISION PER I.C. COMMENTS.
2. REV. 11/09/05, REVISION LOT LAYOUT PER CLIENT REQUEST.
3. REV. 3/9/06, "RECORD DRAWING"

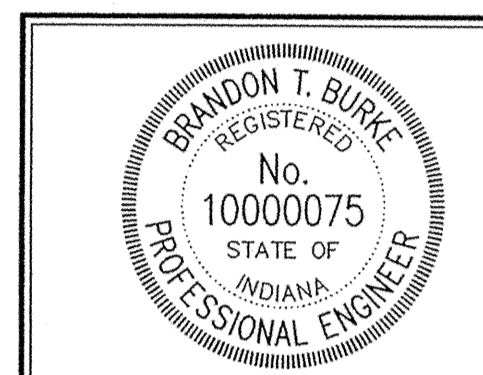

Brandon T. Burk
DATE: 6/10/05
THIS DRAWING AND THE IDEAS, DESIGNS AND CONCEPTS CONTAINED HEREIN ARE THE EXCLUSIVE INTELLECTUAL PROPERTY OF THE SCHNEIDER CORPORATION AND ARE NOT TO BE USED OR REPRODUCED, IN WHOLE OR IN PART, WITHOUT THE WRITTEN CONSENT OF THE SCHNEIDER CORPORATION.
© COPYRIGHTED BY THE SCHNEIDER CORP. (2004)



THE SCHNEIDER CORPORATION
12821 E. New Market Street
Suite 100
Carmel, IN 46032
Telephone: 317.569.8112
Fax: 317.826.6410
www.schneidercorp.com

Architecture
Civil Engineering
Environmental Engineering
Geotechnical Services
GIS * LIS
Home Builder Services
Interior Design
Land Surveying
Landscape Architecture
Transportation Engineering

Village of WestClay
SECTION 9003
CARMEL, INDIANA
BRENNICK DEVELOPMENT CO.
CARMEL, INDIANA

DATE: 6/10/05	PROJECT NO.: 1238.9003
DRAWN BY: DCC	CHECKED BY:
SHEET TITLE: STORM SEWER PLAN & PROFILE	
DRAWING FILES: N:\1238\9003\DWG\SC601-602.DWG XREF: 1012-BS.DWG XREF: 9002-BS.DWG, 9003-BS.DWG XREF: STORM.DWG XREF: CA16.DWG	
SHEET NO.:	

C602

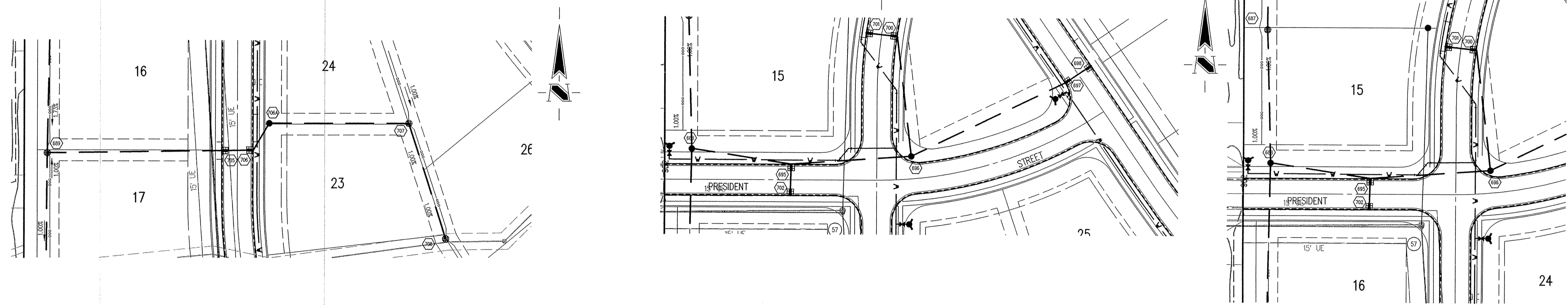

STORM SEWER PLAN

SCALE: 1"=50'

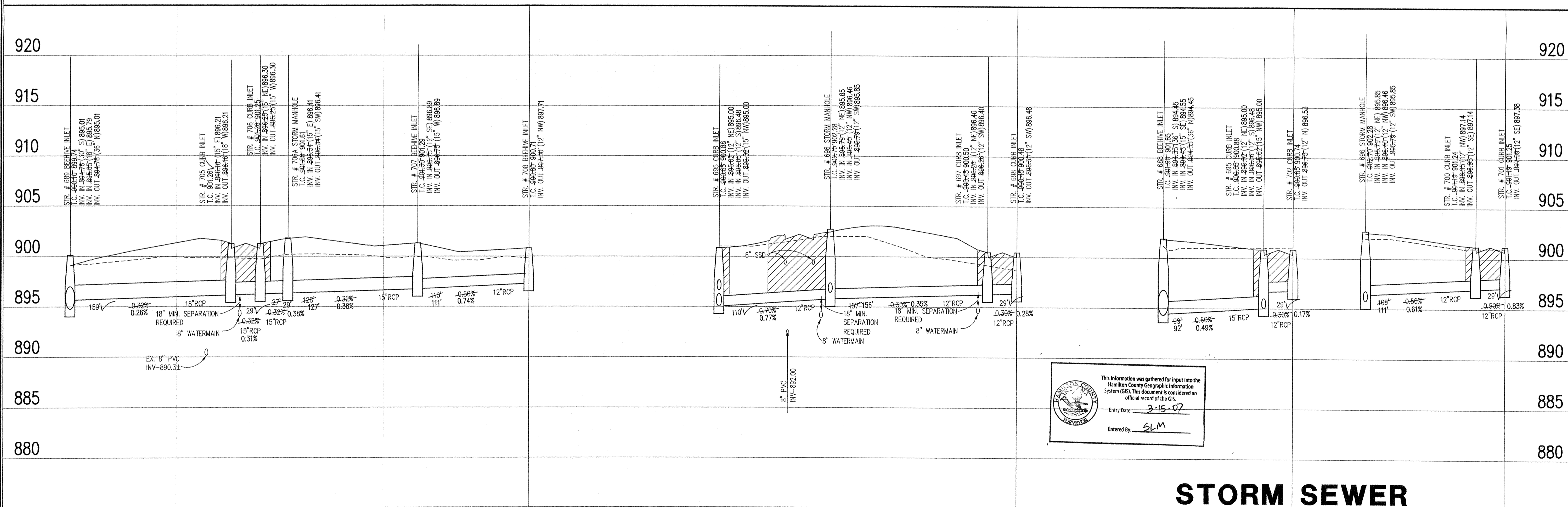

This information was gathered for input into the Hamilton County Geographic Information System (GIS). This document is considered an official record of the GIS.
Entry Date: 3-15-07
Entered By: SLM

STORM SEWER RECORD DRAWING

STORM SEWER PROFILE

LEGEND		
	Existing Grade	
	New Grade	
	Granular Backfill	

SCALE: HORZ.: 1"=50'
VERT.: 1"=5'